

West Station Area Transit Study

Public Meeting



Jackson-Mann Community Center, Allston

November 14, 2019

Agenda

- ❑ **Overview of West Station Area Transit Study (6:30-7:00)**
- ❑ **Small Group Activity (7:00-7:30)**
 - **Desired Outcomes for West Station**
 - **Documenting Progress**
- ❑ **Report Out/Feedback (7:30-7:50)**
- ❑ **Review and Next Steps (7:50-8:00)** we'll be around afterwards to answer questions

West Station Area Transit Study -- Study Purpose

- Provide municipal and state governments, stakeholders, and the development community, with an **objective evaluation of the strategies that could best improve access** to jobs, labor, housing, healthcare, and other major destinations **under different potential development futures** both around West Station and the surrounding community.

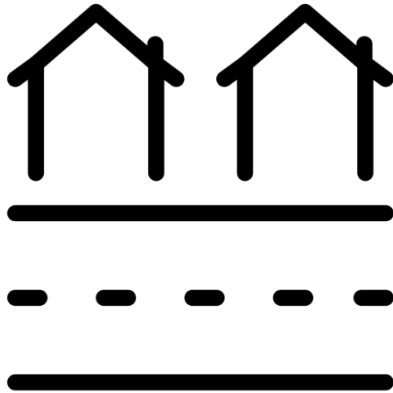

Created by Flatart from Noun Project

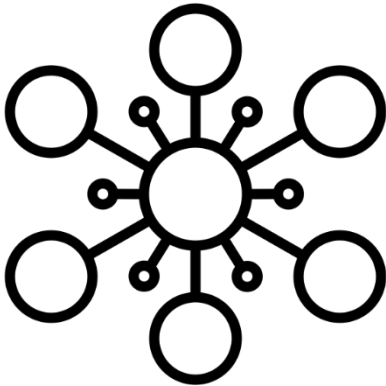

Created by twist.glyph from Noun Project



Created by Adrien Coquet from Noun Project

West Station Area Transit Study -- Study Purpose

- Help municipal and state governments to **proactively plan for and implement regional mobility improvements** as well as **sustainable housing and economic development** as the realigned Allston I-90 interchange area is developed.

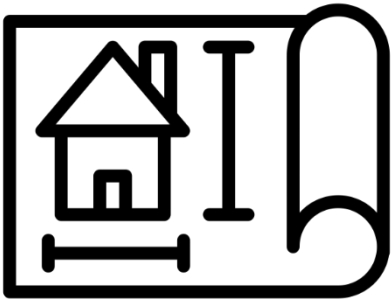

Created by Satawat Anukul
from Noun Project

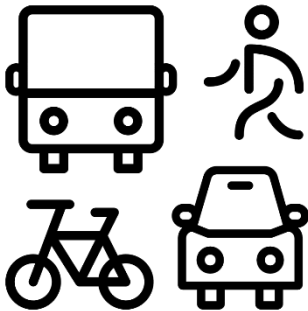

Created by Julynn B.
from Noun Project

West Station Area Transit Study -- Study Purpose

- ❑ Prioritize **transit services concepts** that the Massachusetts Department of Transportation (MassDOT) can use to **inform the design of the new West Station.**

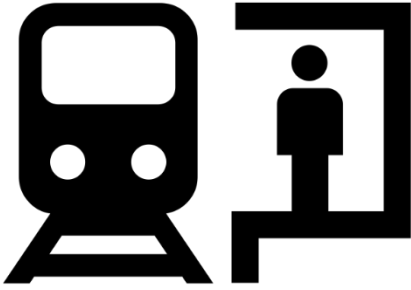

Created by Luis Prado
from Noun Project

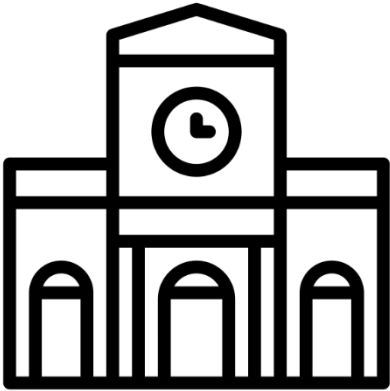

Created by iconixar
from Noun Project

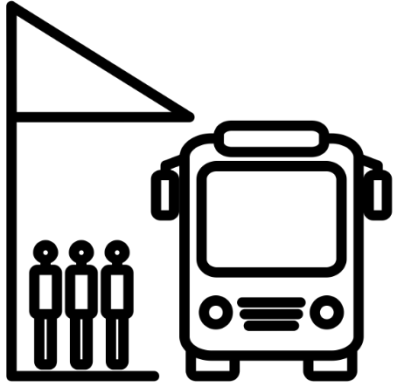

Created by Tomi Triyana
from Noun Project

Allston I-90 Project

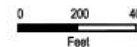
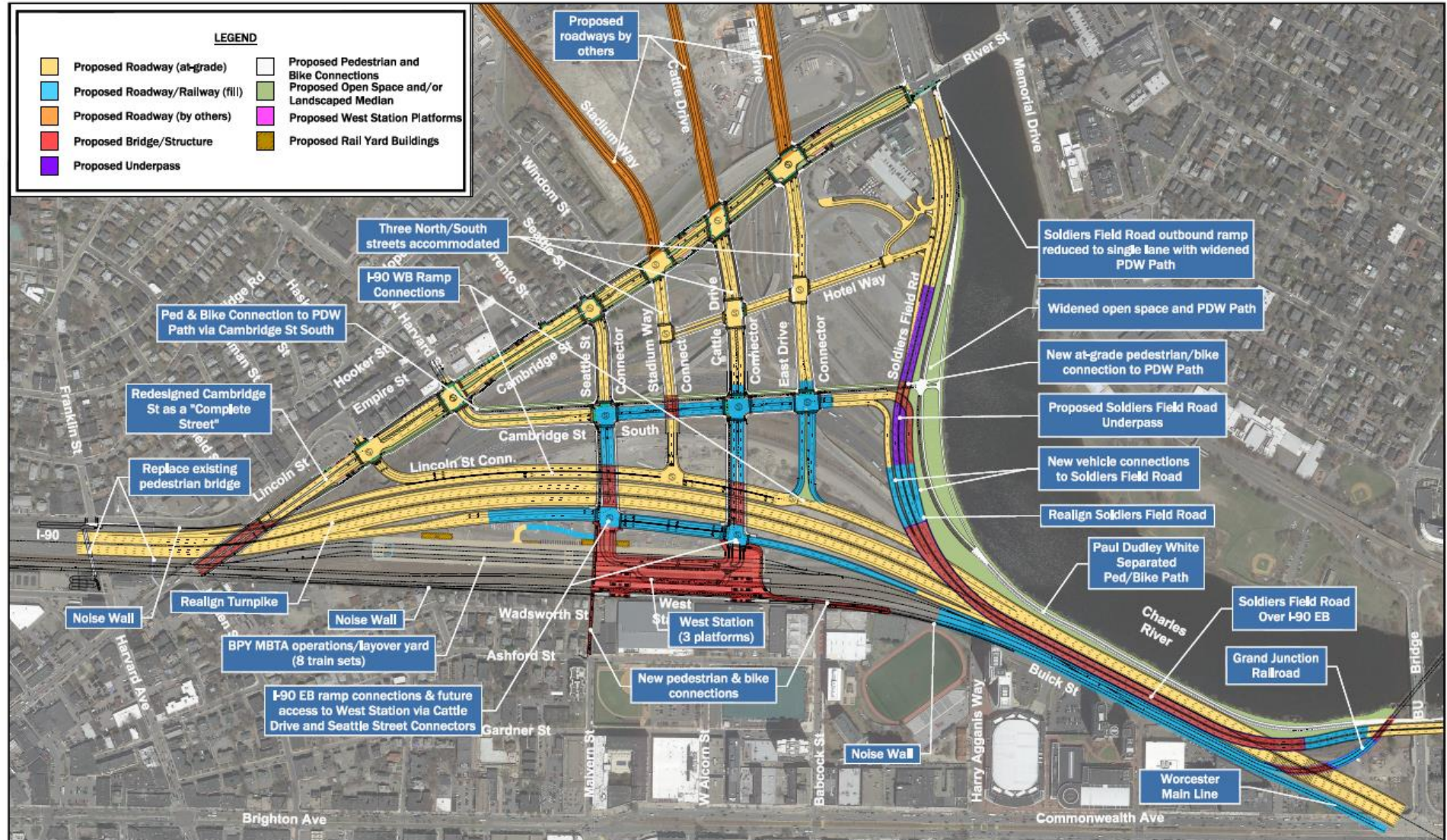

DRAFT

Allston Multimodal Project
Allston, Massachusetts
February 2019

**Highway At-Grade
Modified Hybrid**

West Station Study Area

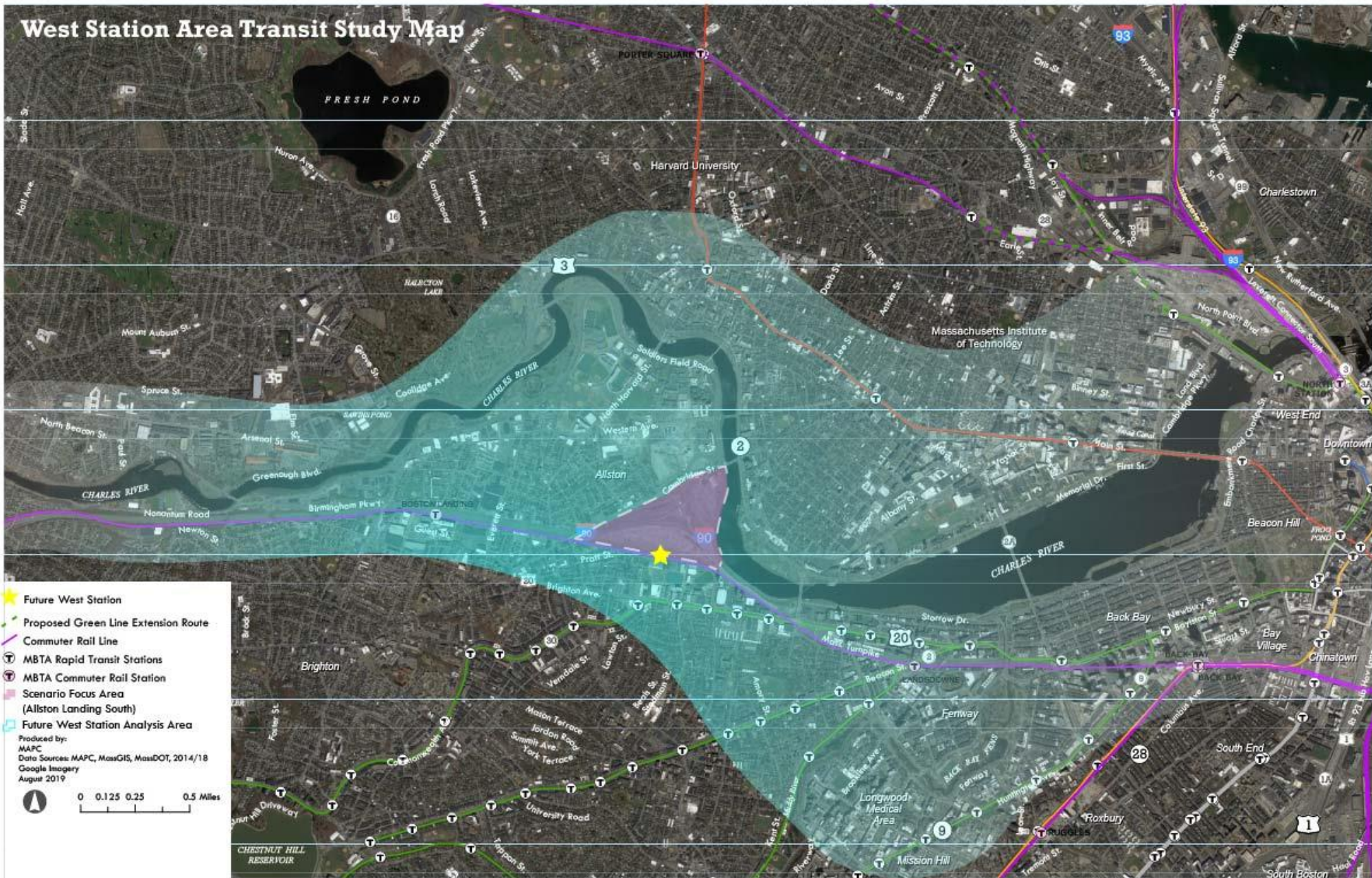

West Station Area Transit Study and Allston I-90 Project

Allston I-90 Project (MassDOT)

- Focus: Design and construction of infrastructure for I-90 interchange area
- Environmental analysis and engineering design
- Specific State and Federal environmental review process
- Includes single land use and transportation “build” scenario
- West Station one of several components
- Specific design of infrastructure for construction projects
- Env. Review (FEIS) and Record of Decision scheduled for Oct. 2021

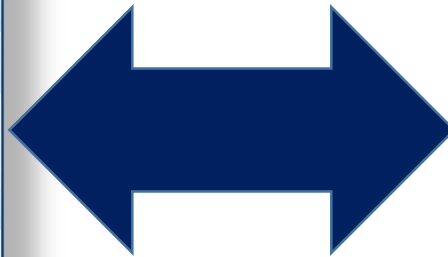

West Station Area Transit Study (MAPC)

- Focus: Prioritize transit services and land use policies for a successful West Station
- Planning level study
- Prompted by Draft Environmental Impact Report (DEIR) certificate
- Includes several “what if” options for land use and transportation
- Helps inform design of West Station
- Creates framework for MassDOT, MBTA, municipalities, private sector
- Planning study recommendations scheduled for Fall/Winter 2020

Technical Approach

Land Use Scenarios

- Develop a range of future land use scenarios for Allston Landing South and surrounding area, varying in density, mix, timing, and design of development
- Includes options in housing type (size, affordability), parking supply/costs, and transportation demand management (TDM) strategies

Transportation Scenarios

- Identify various transit services, new connections, and active transportation facilities
- Includes options on span of service for rail/bus

Transportation Accessibility Modeling

- Adapt existing accessibility-based tools and forecasts to estimate trips, destinations, and mode choice for each land use and transportation scenario

Testing

- Use rapid iterations of land use scenarios and transportation model to identify services, connections, and policies that achieve desired outcomes

Accessibility Model and Scenario Testing

Model will help evaluate benefits of transportation and land use options:

- Requires only conceptual level of inputs
- Sensitive to different incomes, household sizes, commercial development
- Accounts for cost and time of transit, parking, tolls, ride-hail, etc.
- Includes walking/bicycling network options

Model will run land use and transportation scenarios in rapid iteration:

- Test out interaction between land use and transportation options
- Assess the impact of specific policies, pricing, service
- Score each alternative based on outcomes and metrics
- Identify most promising transport options for each land use scenario; highlight those valuable for all scenarios

We Want Your Feedback on Desired Outcomes and Metrics ...



- What outcomes are most important for evaluating options for a future West Station?

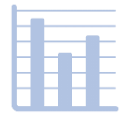
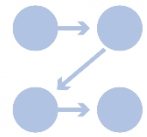

- What are the best measures for determining if a transportation or land development scenario is effective?



Draft Study Desired Outcomes

A successful West Station and associated transportation improvements will...

- A. Improve convenient and efficient transit access throughout the Inner Core and for points west of the city
- B. Contribute to improved reliability, safety, and resilience of the MBTA system
- C. Reduce per-capita car trips, and vehicle miles travelled (VMT) of residents and workers in West Station area
- D. Shift more auto trips regionwide to transit, walking, and cycling
- E. Encourage compact, walkable growth with a strong sense of place
- F. Improve job access and transit equity for lower-income households
- G. Expand housing opportunities including affordable housing in the Inner Core
- H. Create financial and economic benefits for the City of Boston and the region

Small Group Discussion At Your Table

Question 1 (10 min):

What outcomes are most important for evaluating options for a future West Station? Would you add any? Would you change any?

Please discuss and revise the Desired Outcomes poster at your table.

Small Group Discussion At Your Table

Question 2 (10 min):

Looking at the Desired Outcomes, how should we document progress towards the most important ones? (How would someone in 2040+ know that we've achieved success and met the desired outcomes?)

Brainstorm and use the flip chart at your table to jot down your ideas.

Some ideas...

- Number of auto trips
- Number or share of transit, walking, cycling trips
- Jobs access
- Labor access
- Affordable housing
- Which geographies are important?
 - To/from West Station
 - Within Allston/Brighton
 - To/from MetroWest
 - Through West Station (Longwood, Cambridge, Downtown Boston)

Small Group Discussion At Your Table

Question 3 (10 min):

Using your three dots, vote on which Desired Outcomes are most important to you.

If there is time, discuss why this outcome is important to you.

Report Out -- Share your group's thoughts

- 1. Desired Outcomes – Revisions? Additions? Which ones most important?**
- 2. How do we measure progress? Success?**
- 3. Any other thoughts?**

What's Next?

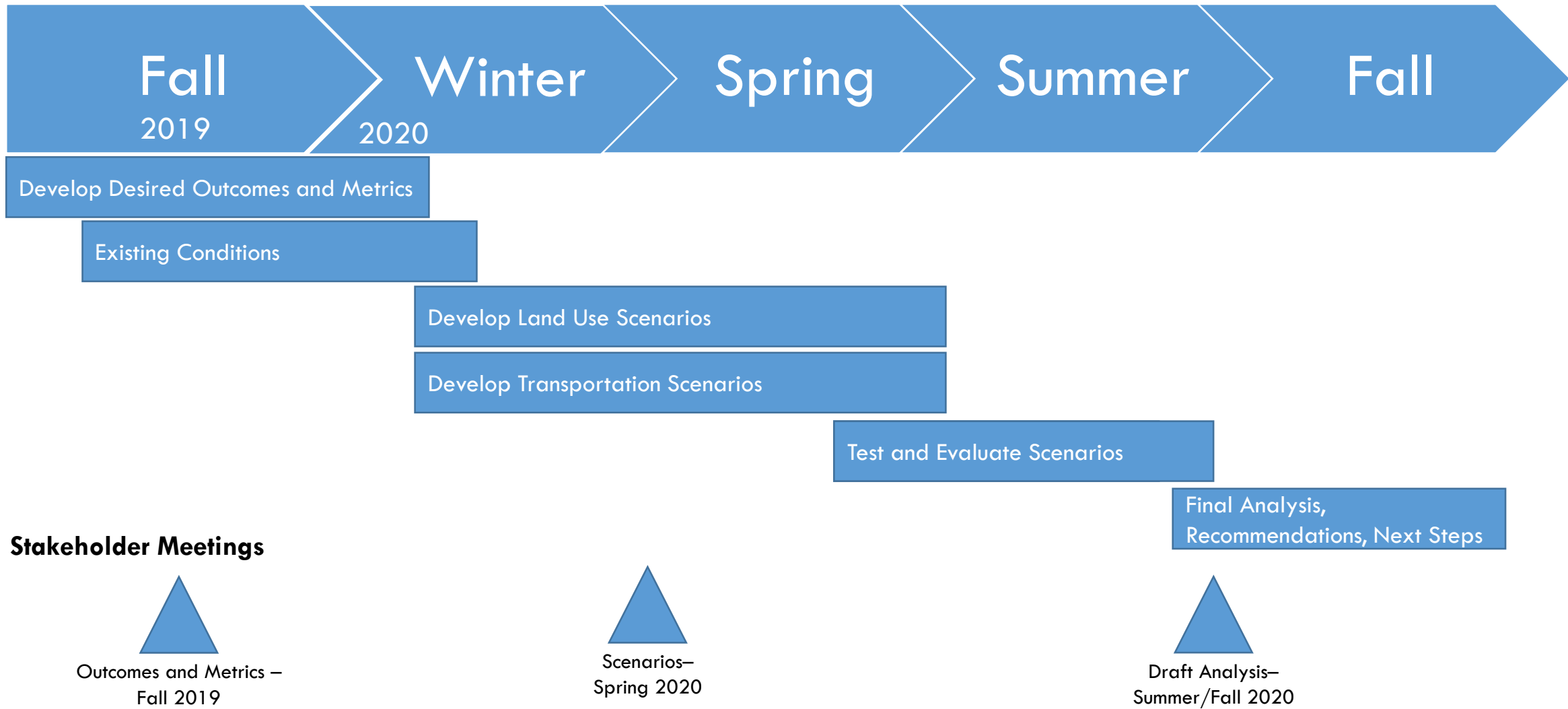

Stay informed!
Connect with us!
Visit our study
webpage

www.mapc.org/weststation

Travis Pollack,
Project Manager
tpollack@mapc.org

West Station Area Transit Study - M X

www.mapc.org/weststation

MAPC METROPOLITAN AREA PLANNING COUNCIL

JOB S METROCOMMON 2050 CALENDAR PRESS ROOM BLOG SEARCH

LEARN OUR WORK GET INVOLVED ABOUT MAPC

SEARCH GO

West Station Area Transit Study

A transportation and land use study by the Metropolitan Area Planning Council

Header photo: Google Maps, @2019 MassGIS, Commonwealth of Massachusetts EOE, Maxar Technologies, Sanborn, USDA Farm Service Agency. Map Data ©2019

ABOUT UPDATES AND UPCOMING EVENTS PAST EVENTS FAQs RELATED STUDIES



Thank you for joining us.

West Station Area Transit Study Team

www.mapc.org/weststation